

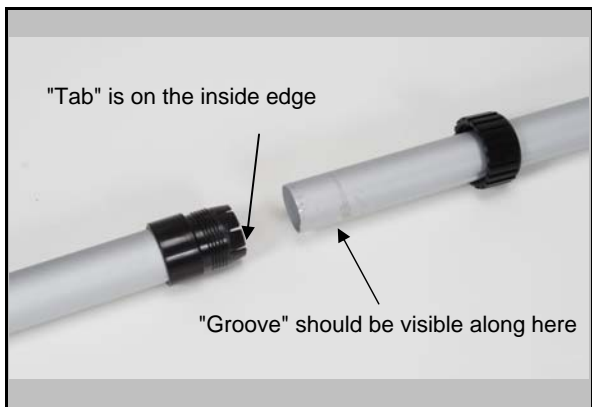

1 Locate both wand pieces and lay them out as pictured in this photograph



2 Remove retaining ring from top section and slide it over the bottom section.



3 Line up the ends and locate the plastic tab inside the hose end. This will align with the groove in the tool end of wand. There is a bump you will need to overcome. Note: it may be difficult to fit the sections together.



4 Slide the retaining ring into place and tighten. Loosen this collar to adjust length and re-tighten to lock in place.



5 Loosen collar and insert tool head. Re-tighten collar to lock in place. Note: The tool is designed to swivel.

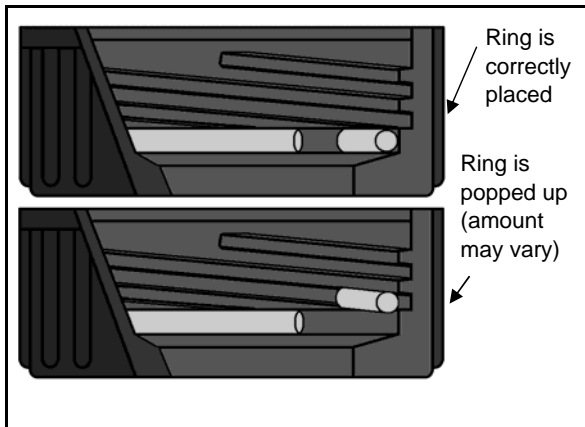

6 Note: Sometimes the locking ring on the inside of the tool-end collar will pop out of place and into one of the threads, preventing the collar from closing all the way. If this happens, the tools will fall out and the collar won't tighten all the way. Push the ring down and out of the threads to remedy. When properly placed and the collar is tightened, the two ends of the rings should touch each other. Above is a cutaway illustration of the collar.